



## Complete Pool and Landscape Packages

- ✓ **CREATIVE 3D DESIGNS** We create customised 3D concepts of your complete pool and landscape project with all finishes and materials included for swim through presentations. Our specialised team of landscape designers offer the latest in outdoor design for your home so let us design your next project in 3D.
- ✓ **PROFESSIONALLY ITEMISED CONSTRUCTION QUOTES** Our detailed construction quotes offer an all inclusive up front package with itemised sections of costs, inclusions, exclusions, allowances and provisional sums, all clearly noted with optional upgrades available for your consideration. Take the hassle and stress out of your project by working with an experienced and professional team you can trust.
- ✓ **PERSONAL SERVICE** We build a limited number of projects each year to guarantee that each of our clients receive the attention, communication and professional project management we are known for. We want your positive referral to your friends and family so we guarantee to do everything we can to insure we get it.
- ✓ **AWARD WINNING BUILDERS** Our team of specialised builders work to the highest industry standards to create luxury pool projects built with both passion and professionalism. Our award winning builders are dedicated and driven to exceed your expectations. Our builders have built projects both nationally and internationally so we guarantee an unmatched level of experience and quality on every project we build from start to finish.
- ✓ **QUALITY FINISHES AND MATERIALS** Our pools use the highest quality materials, finishes and interiors including natural stone, polished pebbles, quartz, glass beads and fully tiled. We guarantee each pool will be an eye-catching creation for your family and friends to enjoy day or night. Let our designers work with you in creating a 3D design with the latest materials and finishes for your next project.
- ✓ **SHOP AT HOME SERVICE** We make the material selections for your new pool and landscaping easy by bringing all the material options to your home for your selection. Let our designers work with you to recommend and create an individual pool that is a reflection of both your lifestyle and your personality. Our pools are as unique as you are and we build for lasting quality not mass produced quantity.
- ✓ **ECO-SMART POOLS** We use the latest technology in fresh water pools and quality energy efficient hydraulic operating systems, which will reduce your chemical reliance and energy use to save you both time and money. Let us create for you a pool that is always clean, fresh, safe and inviting without the ongoing cost of heavy chemicals and cleaning. At Ecozen we offer you the latest in eco-smart pool construction technology on every project.
- ✓ **A COMPLETE SERVICE** We specialise in working with you to offer a complete design and construction experience from initial concept design through construction to final handover. Contact the Ecozen team today and let us show you the future of pool building.



## The “Eco” in Ecozen

**At Ecozen we specialise in providing our clients eco smart pool and landscape packages**

### 1 Energy Efficient Pools

All of our swimming pools come with the latest energy efficient variable speed pool pumps as standard.

These variable speed pumps will reduce your power consumption by over 70% when compared to a standard pool pump. This will save you money whilst reducing your impact on the environment.

### 2 Eco Water

Our swimming pools are either Mineral or Fresh water. They do not require harsh chemicals, are soft on the skin and eyes when swimming and cost less to run and maintain.

The water can be used on the garden when backwashing, achieving a second use.

Our fresh water pools are an ideal solution for you and the environment.

### 3 Energy Efficient Options

From heating to cleaning, we can advise on and install the most environmentally friendly operating systems and eco smart accessories for your new pool.

### 4 Carbon Neutral Construction

At Ecozen we carbon offset all our projects to make the entire construction a carbon neutral process. This carbon offset programme is unique to Ecozen and one we offer to our clients at no extra cost.

Once the total amount of carbon is calculated for your pool, approx 30 tonnes of CO<sub>2</sub> on average for an 8m x 4m pool, we then offset this total amount of carbon produced by planting out enough native trees, approx 200 trees, to balance out the carbon created in building your pool. Once your pool project has been completed it is then certified and the clients are provided with this certificate of carbon neutral construction from an independent auditing service.

We are proud partners and members of the Carbon Neutral Plant A Tree Programme. This is an Australian company which offers all Ecozen clients the option to carbon offset their pool construction via their native bush regeneration programmes.



# DESIGN



## Our designs are as individual as you are.



Every Ecozen project is customised, individually designed and professionally presented to you in a completed 3D render.

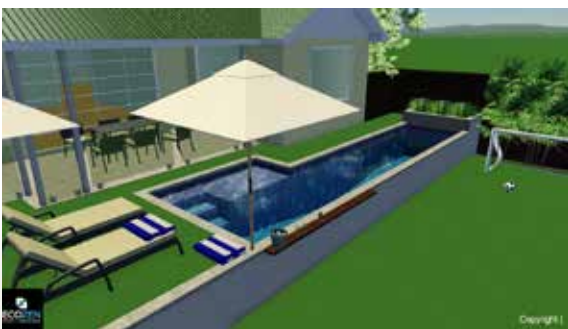

This allows you to get a real feel for the end product and to make any changes required to ensure the design exceeds your expectations.



We design our projects by considering your individual lifestyle, your family, your site, your home and how you will use your pool.

Our specialised team of award winning pool and landscape designers offer the latest in contemporary outdoor design, delivered to you with the professional service we are known for.

For a complimentary on site consultation, 3D design and a professionally itemised quote please contact us today on 1800 326 936 or [info@ecozen.com.au](mailto:info@ecozen.com.au)

**Call us on 1800 326 936**



# PACKAGE DEALS

## The Family Pool Package

**\$32,950 Inc GST**



7m long x 3m wide = 20 lineal metres in any shape

## The Resort Pool Package

**\$37,950 Inc GST**



8m long x 4m wide = 24 lineal metres in any shape

### STANDARD INCLUSIONS

- All engineering design, certification & council approvals with documentation provided.
- Site excavation and soil removal up to the value of \$4,000 for the pool dig.
- QBCC licensed pool and landscape builders with Master Builders accreditation, Ecozen uses Master Builders contracts and insurances for peace of mind in working with qualified, experienced industry professionals.
- Steel reinforced concrete pool 7m long x 3m wide = 20 lineal meters in any shape.
- Play benches, resort steps and standard pool depths from 1.2m to 1.8m deep.
- Variable speed eco pumps and glass bead medium filters for energy efficiency.
- Deluxe skimmer box & oversized basket, high pressure 40mm pipes, eyeball covers & pressure release main drain in base of the pool.
- Provisional plumbing included to the corner of the house for a future heating system.
- Polished 1-2mm ocean pebble and quartz interior of the owner's choice.
- Include the supply and installation of a 300mm deep ceramic waterline tile, a 50mm bench edge tile and a 50mm step edge tile.
- 400mm single bull nose coping of the owner's choice with a tiled skimmer box lid.
- LED Colour changing pool light, operated by the free pool remote control system upgrade.
- Salt water pool chlorinator and timer for automatic pool balancing and cleaning.
- Robotic automatic pool cleaner, free from the skimmer box and independent of the pool pump for maximum cleaning efficiency of your new pool to save you time.

- All engineering design, certification and council approvals with documentation provided.
- Site excavation and soil removal up to the value of \$4,000 for the pool dig.
- QBCC licensed pool and landscape builders with Master Builders accreditation, Ecozen uses Master Builders contracts and insurances for peace of mind in working with qualified, experienced industry professionals.
- Steel reinforced concrete pool 8m long x 4m wide = 24 lineal meters in any shape.
- Play benches, resort steps and standard pool depths from 1.2m to 1.8m deep.
- Variable speed eco pumps and glass bead medium filters for energy efficiency.
- Deluxe skimmer box and oversized basket, high pressure 40mm pipes, eyeball covers and a pressure release main drain in the base of the pool.
- Provisional plumbing included to the corner of the house for a future heating system.
- Polished 1-2mm ocean pebble and quartz interior of the owner's choice.
- Include the supply and installation of a 300mm deep ceramic waterline tile, a 50mm bench edge tile and a 50mm step edge tile.
- 400mm single bull nose coping of the owner's choice with a tiled skimmer box lid.
- LED Colour changing pool light, operated by the free pool remote control system upgrade.
- Salt water pool chlorinator and timer for automatic pool balancing and cleaning.
- Robotic automatic pool cleaner, free from the skimmer box and independent of the pool pump for maximum cleaning efficiency of your new pool to save you time.

Our unique service offers all inclusive pool and landscape packages, including fencing, paving, retainer walls and gardens all at package deal prices. Our packages will save you money and time. **Contact Ecozen and let the professionals design and build your dream project today.**

## The Family Pool and Landscape Package

**\$38,900 Inc GST**

- Supply and construct a new 20 l/m steel reinforced concrete pool ready to swim with all inclusions as noted in the Family Pool Package.
- Supply and install 5 m<sup>2</sup> of a stone tile of the client's choice up to \$55 /m<sup>2</sup> , on a new steel reinforced concrete slab with a full grout finish.
- Supply and install 10 l/ms of the powder coated aluminium pool fencing in the client's choice of colour and style. Include 1 x safety gate and certification on completion.
- Supply and install 10 m<sup>2</sup> of new semi advanced feature gardens around the pool area.
- Include the plants, the mulch, the garden soil and the timber edging.
- Supply and install 20 m<sup>2</sup> of new top soil and quality turf for the back yard area.

## The Resort Pool and Landscape Package

**\$48,900 Inc GST**

- Supply and construct a new 24 l/m steel reinforced concrete pool ready to swim with all inclusions as noted in the Resort Pool Package.
- Supply and install 10 m<sup>2</sup> of a stone tile of the client's choice up to \$55 /m<sup>2</sup>, on a new steel reinforced concrete slab with a full grout finish.
- Supply and install 15 l/ms of the powder coated aluminium pool fencing in the client's choice of colour and style. Include 1 x safety gate and certification on completion.
- Supply and install 15 m<sup>2</sup> of new semi advanced feature gardens around the pool area.
- Include the plants, the mulch, the garden soil and the timber edging.
- Supply and install 20 m<sup>2</sup> of new top soil and quality turf for the back yard area.

## The Entertainer Pool and Landscape Package

**\$59,900 Inc GST**

- Supply and construct a new 28 l/m steel reinforced concrete pool ready to swim with all inclusions as noted in the Resort Pool Package.
- Supply and install 20 m<sup>2</sup> of a stone tile of the client's choice up to \$55 /m<sup>2</sup>, on a new steel reinforced concrete slab with a full grout finish.
- Supply and install 20 l/ms of the powder coated aluminium pool fencing in the client's choice of colour and style. Include 1 x safety gate and certification on completion.
- Supply and install 25 m<sup>2</sup> of new semi advanced feature gardens around the pool area.
- Include the plants, the mulch, the garden soil and the timber edging.
- Supply and install 40 m<sup>2</sup> of new top soil and quality turf for the back yard area.



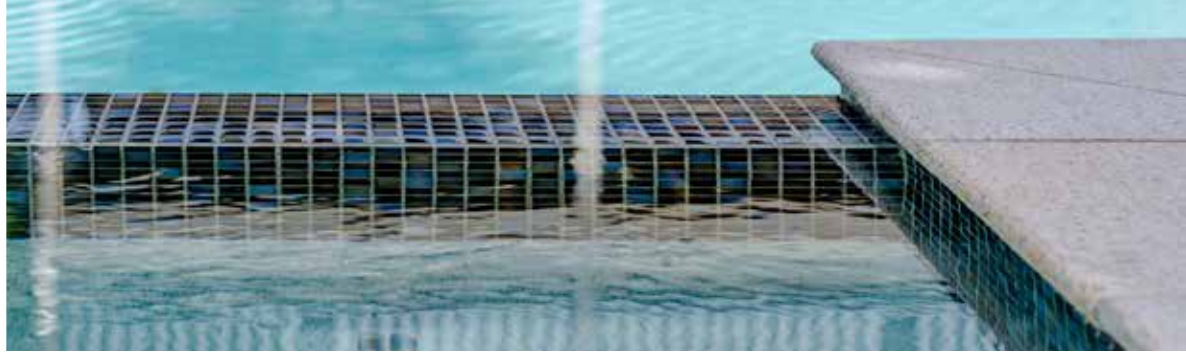
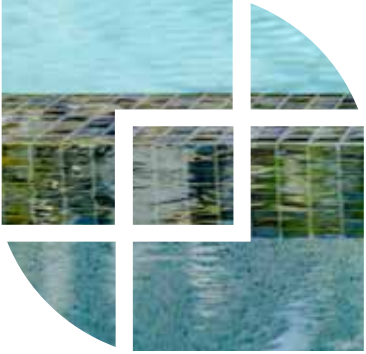

# Building your pool at the same time as your new home

**Building your pool at the same time as your new home has many benefits.**

- Your new pool will be completed and ready for you to enjoy when you move in.
- The pool location can be optimised as part of the house design and left clear of pipes.
- You will save money on the pool excavation costs by installing the pool with the house build, as access can be greatly reduced after the house is built.
- No construction after the house completion disrupting your new home and landscaping.
- The filtration location, power, pipes, fencing and tiling can all be designed and considered at the same time as the house for a flawless finish and efficient construction.
- The end result will create a pool and landscape space that has been designed as part of the home not an afterthought. This allows us to match your style, materials and finishes.





## Some things to consider when building a pool at the same time as your house.

**POOL SAFETY COVER / TEMP FENCE** - Depending on the proximity of the pool to the house, the house builder may need the pool boarded/covered for the duration of the house build for safety. This is an additional expense that can be coordinated via your house builder or pool builder. Depending on the build time, temporary fencing may be needed for an extended time. The costs of covering and/or fencing the pool shell during the house build are usually made up for by the savings on the pool excavation costs by installing the pool before the house goes in. Having greater access for the pool dig saves you money.

**SURVEYING** - As there are generally no reference points when the pool is being profiled and positioned on site, you will may need to pay an additional surveying fee of approx \$500 to have the pool/boundary/house positions surveyed on site before the house build. This ensures the pool position and heights are accurate. If the boundaries are accurate the house builder may offer this as a free service.

**PIERING / FOUNDATIONS** - Depending on the proximity of the pool to the house, the new house may require piercing or additional foundations in places to allow for the pool. This is done through your house builder.

**PIPES / SERVICES** - Knowing the location of the pool early in your design process will allow you builder to keep all services and underground pipes clear of the pool zone.

**FILTRATION STATION LOCATION / BACK WASH** - Ideally, you will want to keep the pool filtration station within 10 metres of the pool and out of the pool zone. Your pool designer can help you with this design to ensure the best location on site. Keep in mind the heights of filtration equipment near windows and pool fences. You will want your house builder to install a back wash outlet/stormwater point at the filtration station.

**ELECTRICALS** - Your house builder will be able to provide power outlets at your filtration station location. This is usually 4 x 10amp outdoor power points. Your pool builder can confirm exact power requirements for your pool. Your pool electrical may also include earthing and garden lighting if required around the pool.

**TILES AND MATERIALS** - Picking your outdoor tiles / pavers early can assist with your pool design, as the size of the pool and the surrounds can be designed to match in with the house tiles for a sleek and modern look. By working with our landscape architects early we can ensure your pool and home are designed together as one complete space for your family to enjoy as soon as you move in.





**Contact us for a 3D concept design  
and an itemised quote for your upcoming project**



**Free Call 1800 326 936 | [www.ecozen.com.au](http://www.ecozen.com.au)**

**QBCC Lic: 1204348**

**Email us at [info@ecozen.com.au](mailto:info@ecozen.com.au)**

